

Instructions for use of the Cosentyx 150 mg SensoReady pen



Cosentyx 150 mg SensoReady pen

Solution for injection in a pre-filled pen

Secukinumab

Patient Instructions for Use



Read ALL the way through these instructions before injecting.

These instructions are to help you to inject correctly using the Cosentyx SensoReady pen.

It is important not to try to inject yourself or the person in your care until you have been trained by your doctor, nurse or pharmacist.

Your Cosentyx 150 mg SensoReady pen:

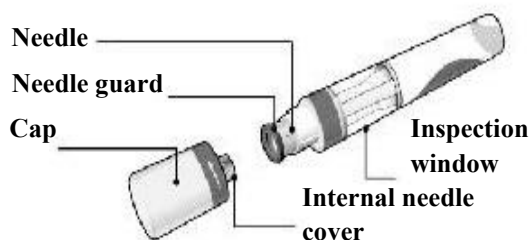

Cosentyx 150 mg SensoReady pen shown with the cap removed. **Do not** remove the cap until you are ready to inject.

Store your boxed pen in a **refrigerator** between 2°C and 8°C and **out of the reach of children**.

- **Do not freeze** the pen.
- **Do not shake** the pen.
- Do not use the pen if it has been **dropped** with the cap removed.

For a more comfortable injection, take the pen out of the refrigerator **15-30 minutes before injecting** to allow it to reach room temperature.

What you need for your injection:

Included in the carton:

A new and unused Cosentyx 150 mg SensoReady pen (1 pen is needed for a 150 mg dose and 2 pens are needed for a 300 mg dose).

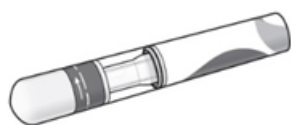

Not included in the carton:

- Alcohol swab.
- Cotton ball or gauze.
- Sharps disposal container.



Before your injection:

1. Important safety checks before you inject:

The liquid should be clear. Its colour may vary from colourless to slightly yellow.

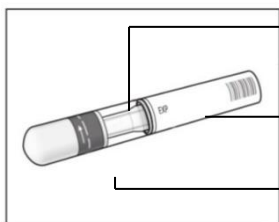

Do not use if the liquid contains easily visible particles, is cloudy or is distinctly brown. You may see a small air bubble, which is normal.

Do not use the pen if the **expiry date** has passed.

Do not use if the **safety seal** has been broken.

Contact your pharmacist if the pen fails any of these checks.

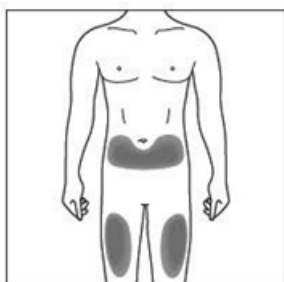

2a. Choose your injection site:

- The recommended site is the front of the thighs. You may also use the lower abdomen, but **not** the area 5 centimetres around the navel (belly button).
- Choose a different site each time you give yourself an injection.
- Do not inject into areas where the skin is tender, bruised, red, scaly or hard. Avoid areas with scars or stretch marks.

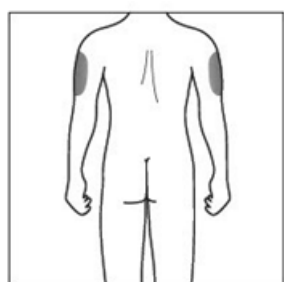

2b. Caregivers and healthcare professionals only:

- If a **caregiver** or **healthcare professional** is giving you your injection, they may also inject into your outer upper arm.



3. Cleaning your injection site:

- Wash your hands with soap and hot water.
- Using a circular motion, clean the injection site with the alcohol swab. Leave it to dry before injecting.
- Do not touch the cleaned area again before injecting.

Your injection:

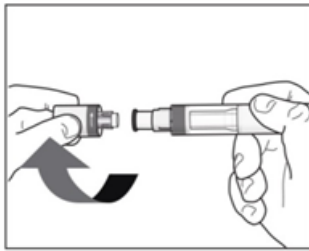

4. Removing the cap:

- Only remove the cap when you are ready to use the pen.
- Twist off the cap in the direction of the arrows.
- Once removed, throw away the cap. **Do not try to re-attach the cap.**
- Use the pen within 5 minutes of removing the cap.



5. Holding your pen:

- Hold the pen at 90 degrees to the cleaned injection site.



Correct



Incorrect



YOU MUST READ THIS BEFORE INJECTING.

During the injection you will hear **2 loud clicks**.

The **1st click** indicates that the injection has started. Several seconds later a **2nd click** will indicate that the injection is **almost** finished.

You must keep holding the pen firmly against your skin until you see a **green indicator** fill the window and stop moving.

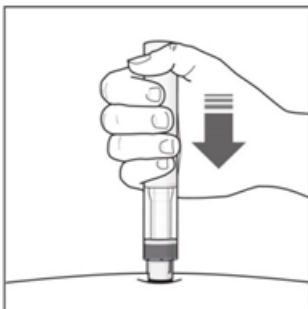

6. Starting your injection:

- Press the pen firmly against the skin to start the injection.
- The **1st click** indicates the injection has started.
- **Keep holding** the pen firmly against your skin.
- The **green indicator** shows the progress of the injection.

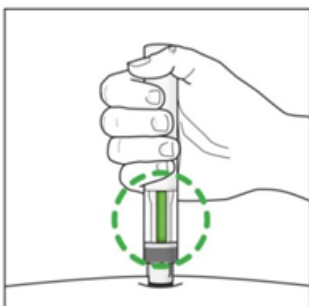

7. Completing your injection:

- Listen for the **2nd click**. This indicates the injection is **almost** complete.
- Check the **green indicator** fills the window and has stopped moving.
- The pen can now be removed.

After your injection:



8. Check the green indicator fills the window:

- This means the medicine has been delivered. Contact your doctor if the green indicator is not visible.
- There may be a small amount of blood at the injection site. You can press a cotton ball or gauze over the injection site and hold it for 10 seconds. Do not rub the injection site. You may cover the injection site with a small adhesive bandage, if needed.

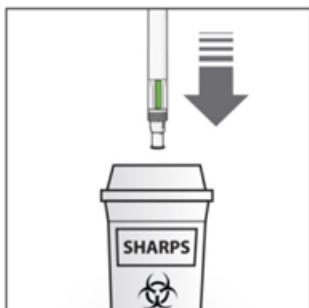

9. Disposing of your Cosentyx SensoReady pen:

- Dispose of the used pen in a sharps disposal container (i.e. a puncture-resistant closable container, or similar).
- Never try to reuse your pen.